



TR-LOC2100 Local Operator Console Product Installation Document

TRIGA Life Safety Systems, LLC
7600 Olde Eight Rd, Hudson, Ohio, 44236-1057
Tel: +1 330-577-5199, Email: info@trigaglobal.com

PN LS10188-003TR-E:B 12/1/2022 ECN: 00003637

1 Description

The TR-LOC2100 Local Operator Console is a combination ECS-RVM Remote Voice Module and its associated TR-RD2G/R keypad annunciator which is compatible with the Emergency Communication System. Additional switches can be added to the ECS system using ECS-SW24 modules, purchased separately.

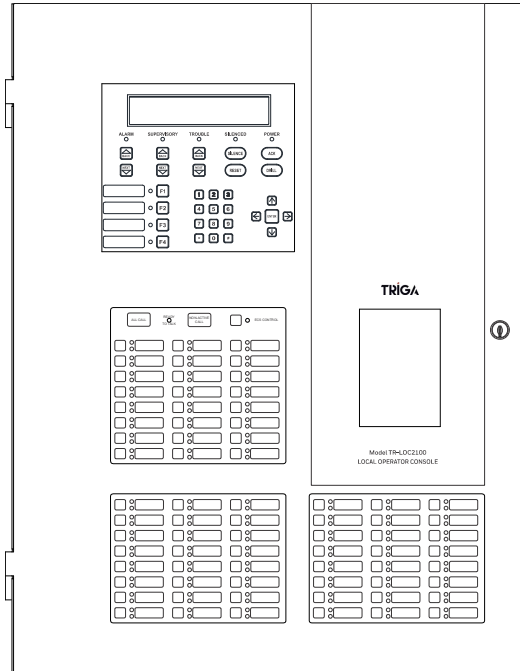

Figure 1 TR-LOC2100 Local Operator Console

1.1 Compatibility

The TR-LOC2100 is compatible with the Triga TR-2100ECS Series FACP.

2 Specifications

These current draws are specified only for one TR-RD2G/R keypad annunciator and one ECS-RVM.

- Standby Current: 93mA
- Alarm Current: 133mA
- Operating Voltage: 24VDC
- Operating Temperature: 32°F - 120°F (0°C - 49°C)

3 Mounting the Cabinet



NOTE: Installation and wiring of this device must be done in accordance with NFPA 72 and local ordinances.

1. Remove the cabinet door and dead front panel by lifting up and sliding them off the two pins in the hinge bracket of the base. The outer hinge pins are used for the door while the inner hinge pins are used for the dead front panel.

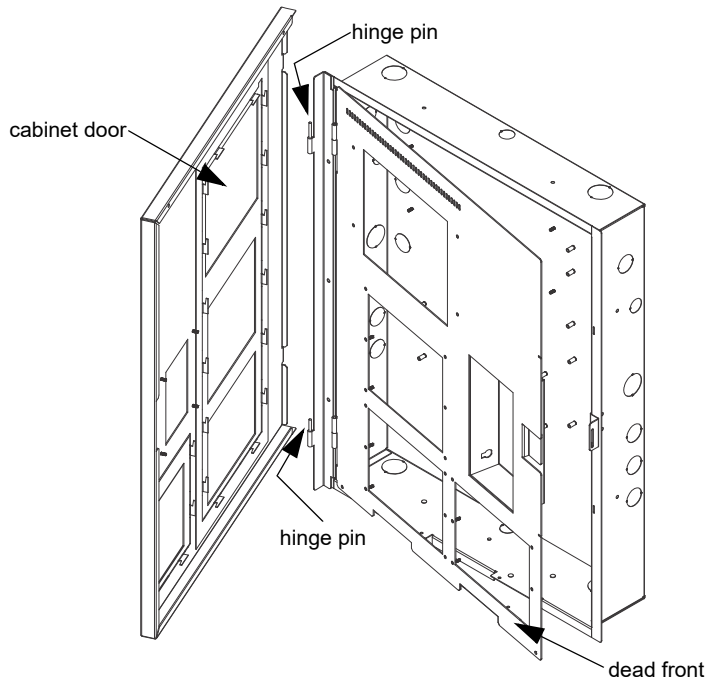

Figure 2 TR-LOC2100 Door and Dead Front

2. Remove AC power and disconnect the backup batteries from the main control panel.
When mounting the cabinet on interior walls, use appropriate screws such as #10 drywall or concrete screws to anchor into plaster.
When mounting the cabinet on concrete, especially when moisture is expected, attach a piece of 19mm plywood to the concrete surface and then attach the TR-LOC2100 to the plywood.

3.1 Surface Mounting

The cabinet can be mounted on wall surfaces by using the mounting holes in the back of the cabinet.

1. Mark and pre-drill the holes in the wall for the center top keyhole mounting bolts using the dimensions in Figure 3.
2. Place the backbox over the top screws, level, and secure the screws.
3. Install the remaining fasteners and tighten.

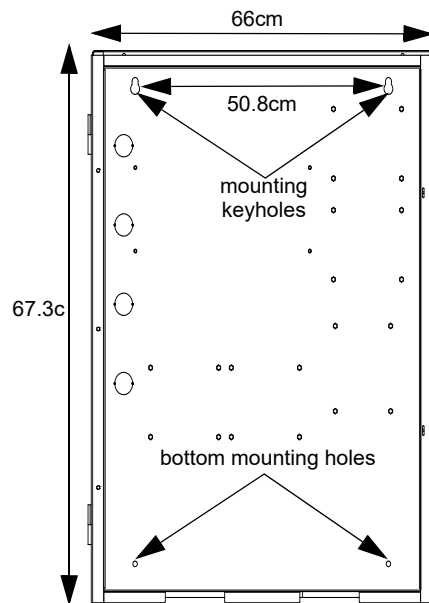

Figure 3 Cabinet Mounting Holes

3.2 Recessed Mounting

Follow these steps to recess mount the cabinet:

1. Cut a recess hole. There should be 3.8cm to 4.4cm of cabinet extruding from the wall, this should be measured from either the top edge or bottom edge to the exterior side of the sheet rock.
2. Mount the cabinet to the wall studs by inserting a screw through the cabinets side mounting holes and then insert it into the wall stud.
3. To reinstall the doors, align the top hinge first, and then align the lower hinge. Lower the door and dead front onto the hinge pins.

4 Wiring

4.1 Board Layout

Figure 4 shows the back view of the TR-LOC2100 board.

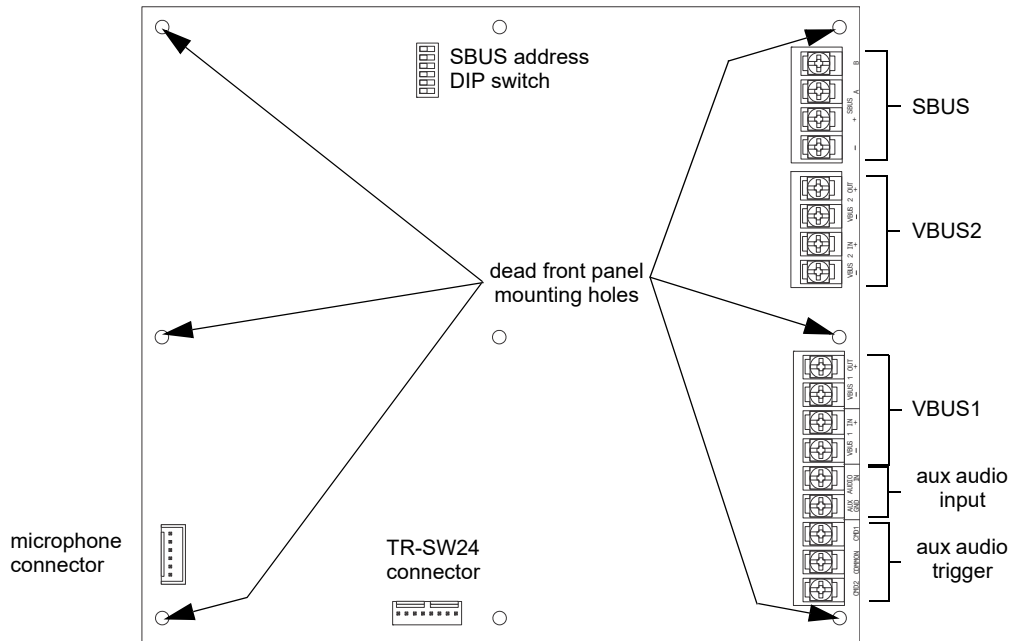

Figure 4 Back View of the TR-LOC2100 Board

4.2 Wiring to the FACP

See Figure 5 to properly wire the TR-LOC2100 to the FACP SBUS.

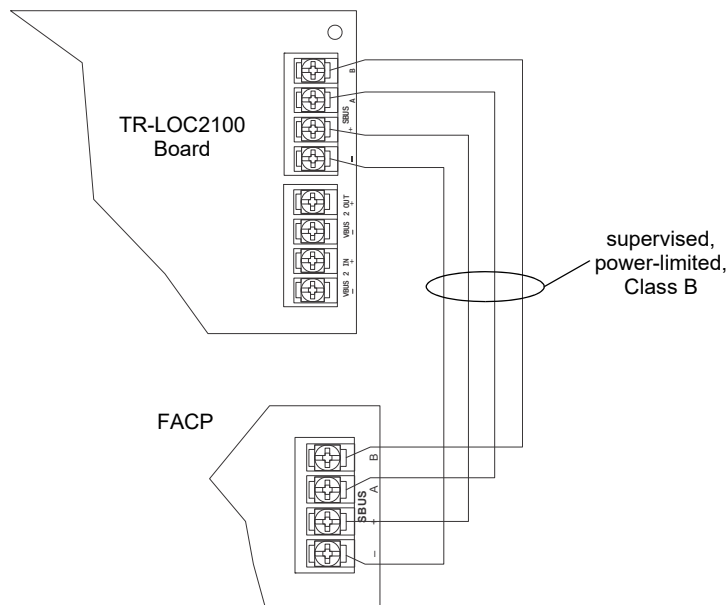

Figure 5 TR-LOC2100 SBUS Connections to the FACP

5 Installing the Microphone

1. Clip the microphone onto the microphone clip.

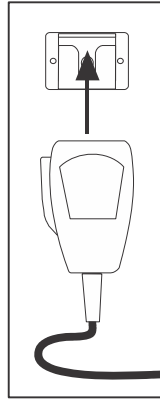

Figure 6 Hang Microphone on Microphone Clip

2. Insert microphone cord through hole at the bottom of the dead front panel.

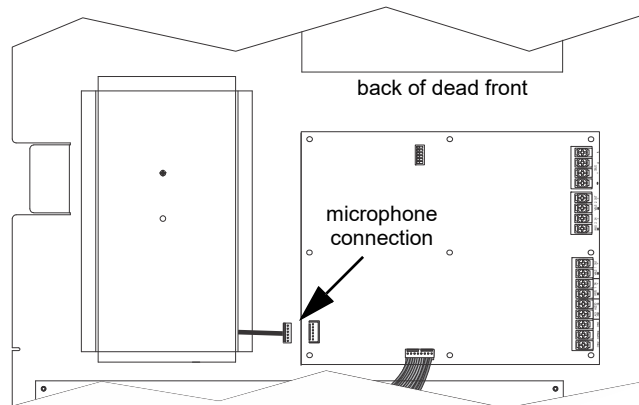

Figure 7 Microphone Cord Inserted Through Dead Front Panel Hole

3. Attach strain relief clip to microphone cord. The strain relief clip should have about 7cm of microphone cord through it.

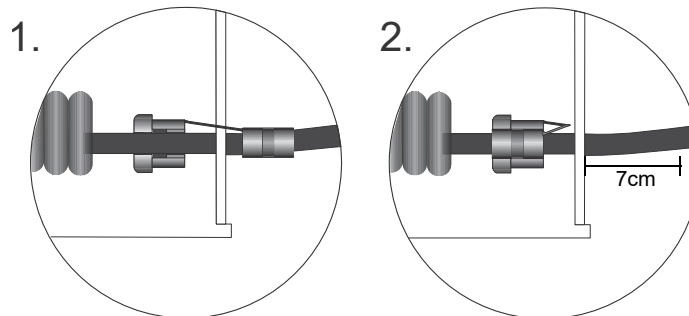

Figure 8 Installing Strain Relief Clip

4. Push the strain into the hole in the dead front panel.
5. Attach connector to the TR-LOC2100 board.
6. Restore AC power and reconnect the backup batteries.

6 Optional Accessory

THUMBLTCH - Turn latch lock (not intended for UL installations).